

# **DEQ EXHIBIT 8**

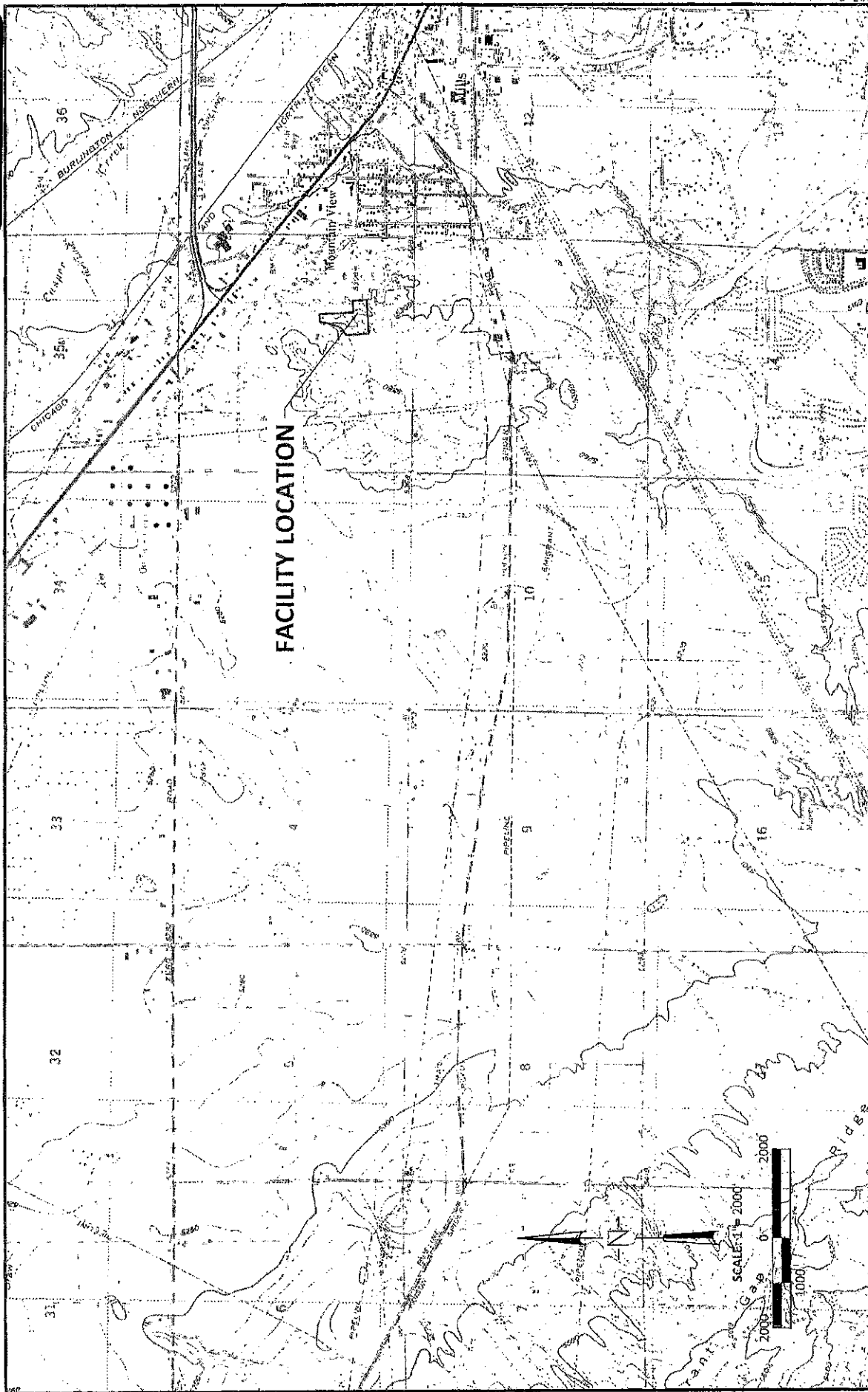

|          |  |                  |  |                 |  |          |  |                      |  |             |  |               |  |              |  |
|----------|--|------------------|--|-----------------|--|----------|--|----------------------|--|-------------|--|---------------|--|--------------|--|
| SCALE    |  | HORIZ 1" = 2000' |  | VERT 1" = 1000' |  | SECTIONS |  | JOB NO. 15203-CE     |  | PAGE 35     |  | DATE          |  | SHEET 1 OF 1 |  |
| DWN. BES |  | RC-1097          |  | JOB NO.         |  | 15203-CE |  | ANCHOR ENVIRONMENTAL |  | DRYING BEDS |  | MILLS WYOMING |  | 1            |  |



**INBERG-MILLER ENGINEERS**  
 124 E 3rd Main Street  
 Riverton, WY 82501  
 307-868-0306

1720 E 4th C Street  
 380 Parkway Boulevard  
 Casper, WY 82407  
 307-252-6667

257 Alton Road  
 Green River, WY 82505  
 307-344-1710

193 Farmers Coop Way  
 Green River, WY 82505  
 307-475-4246

This work was prepared under contract to the Wyoming Department of Environmental Quality. The user of this work shall be at the Client's risk and full legal responsibility.