

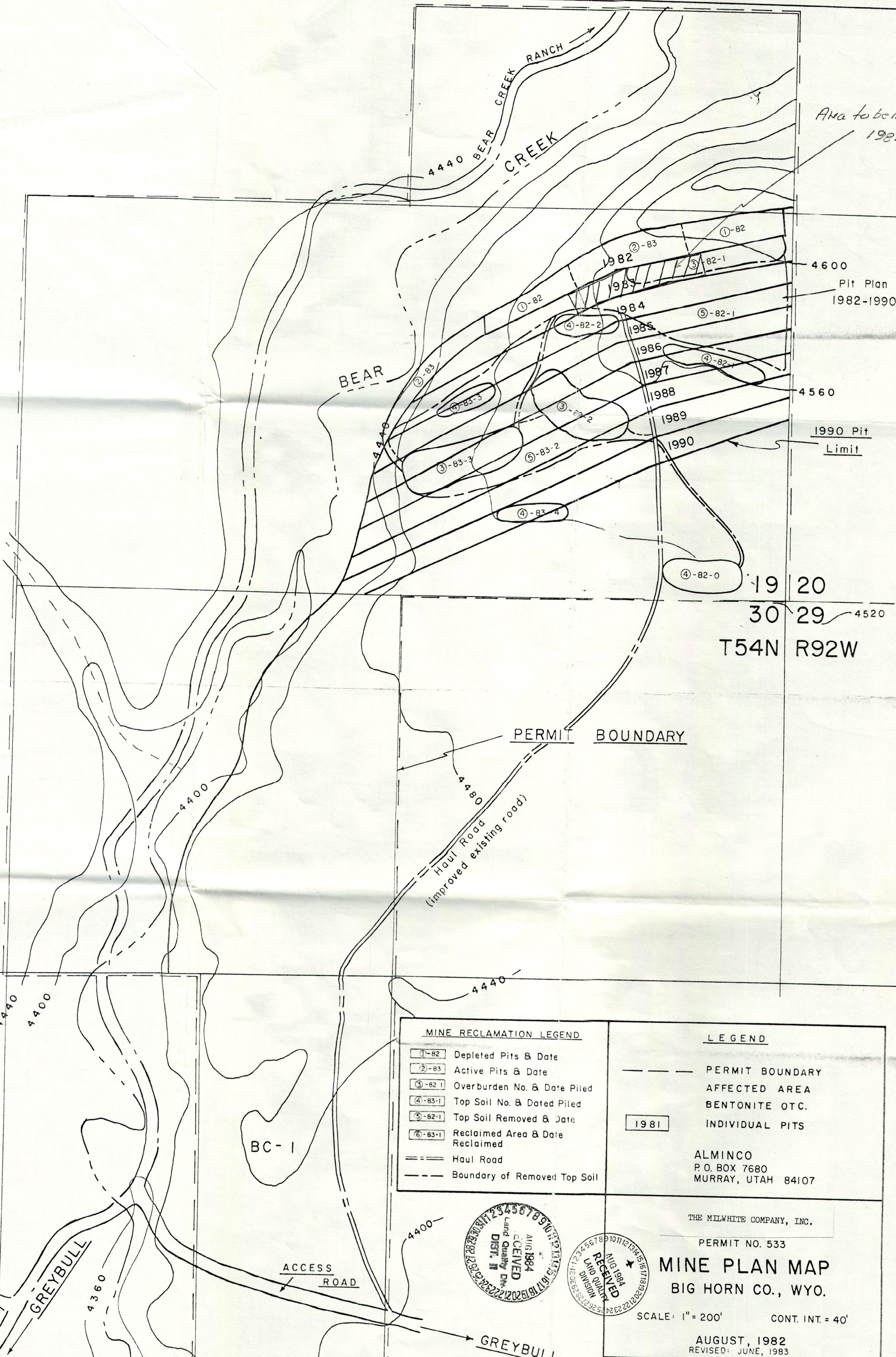

*Ava to be mined  
1984*



4600  
Pit Plan  
1982-1990

4560

1990 Pit  
Limit

19 20

30 29 4520

T54N R92W

PERMIT BOUNDARY

Haul Road  
(Improved existing road)

BC-1

ACCESS ROAD

**MINE RECLAMATION LEGEND**

①-82	Depleted Pits & Date
②-83	Active Pits & Date
③-82-1	Overburden No. & Date Piled
④-83-1	Top Soil No. & Dated Piled
⑤-82-1	Top Soil Removed & Date
⑥-83-1	Reclaimed Area & Date Reclaimed
==	Haul Road
- - -	Boundary of Removed Top Soil

**LEGEND**

- - -	PERMIT BOUNDARY
---	AFFECTED AREA
---	BENTONITE OTC.
1981	INDIVIDUAL PITS
ALMINCO P.O. BOX 7680 MURRAY, UTAH 84107	

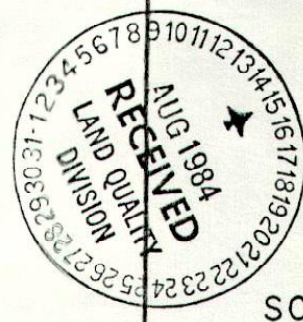

THE MILWHITE COMPANY, INC.

PERMIT NO. 533

**MINE PLAN MAP**  
BIG HORN CO., WYO.

SCALE: 1" = 200' CONT. INT. = 40'

AUGUST, 1982  
REVISED: JUNE, 1983

LICENSE NO. 533 L3

**Exhibit DEQ 7**